

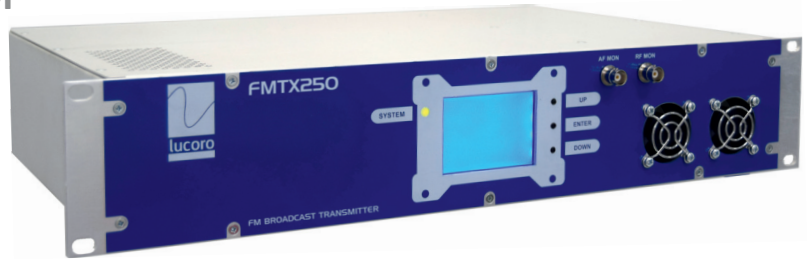

250 Watt FM Transmitter

FMTX250M



Features

- Up to 250W RF output power
- Linear PLL modulator
- MPX input
- Latest enhancement mode FET RF amplifier

Applications

- Exciter or Transmitter
- Independent radio service
- Community radio service
- Special event and emergency stations

With 250W output power, the FMTX250/M is perfect for cost conscious radio stations who demand uncompromising performance. It meets or exceeds EMC and safety standards, and is compliant with broadcast regulations. Reliability and efficiency is ensured by careful design and the use of high quality components.

Ideal for broadcast sites fed by analogue (multiplex baseband) STL feeds, or for users who prefer to specify their own processor and stereo / RDS coders.

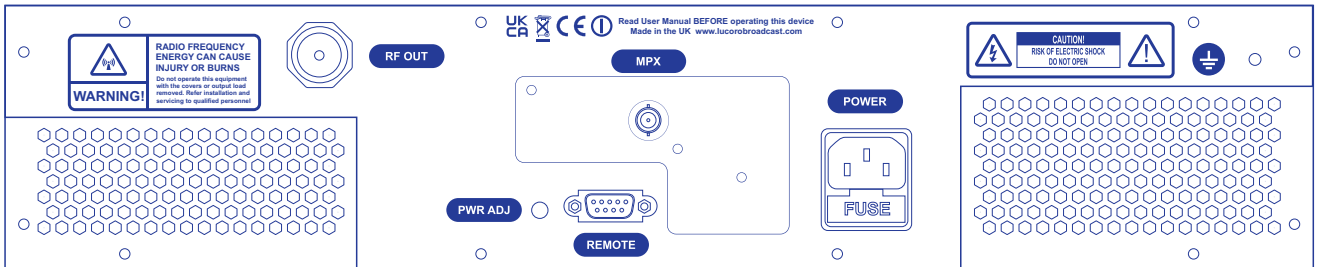

Specifications

Dimensions:	2U 88 H x 482 W x 350 D (mm)	Frequency:	87.5 - 108MHz
Weight:	5.0kg	Output Power:	30 - 250W
MPX input:	BNC	Harmonics & Spuri:	-75dBc typical
RF output:	N female 50ohm	Voltage:	100 - 250Vac 50-60Hz
I/O Control:	9-way D-sub female	Compliance:	EN302018, EN301489

Lucoro Broadcast
www.lucorobroadcast.com sales@lucorobroadcast.com
 Lucoro Ltd, Clay Pit lane, Bar lane Industrial Estate, Rocliffe, York, YO51 9FS United Kingdom

We reserve the right to alter specifications without notice. E&OE. Photographs and illustrations are for guidance only and do not form a contract.